

**DETAIL-A**  
NTS

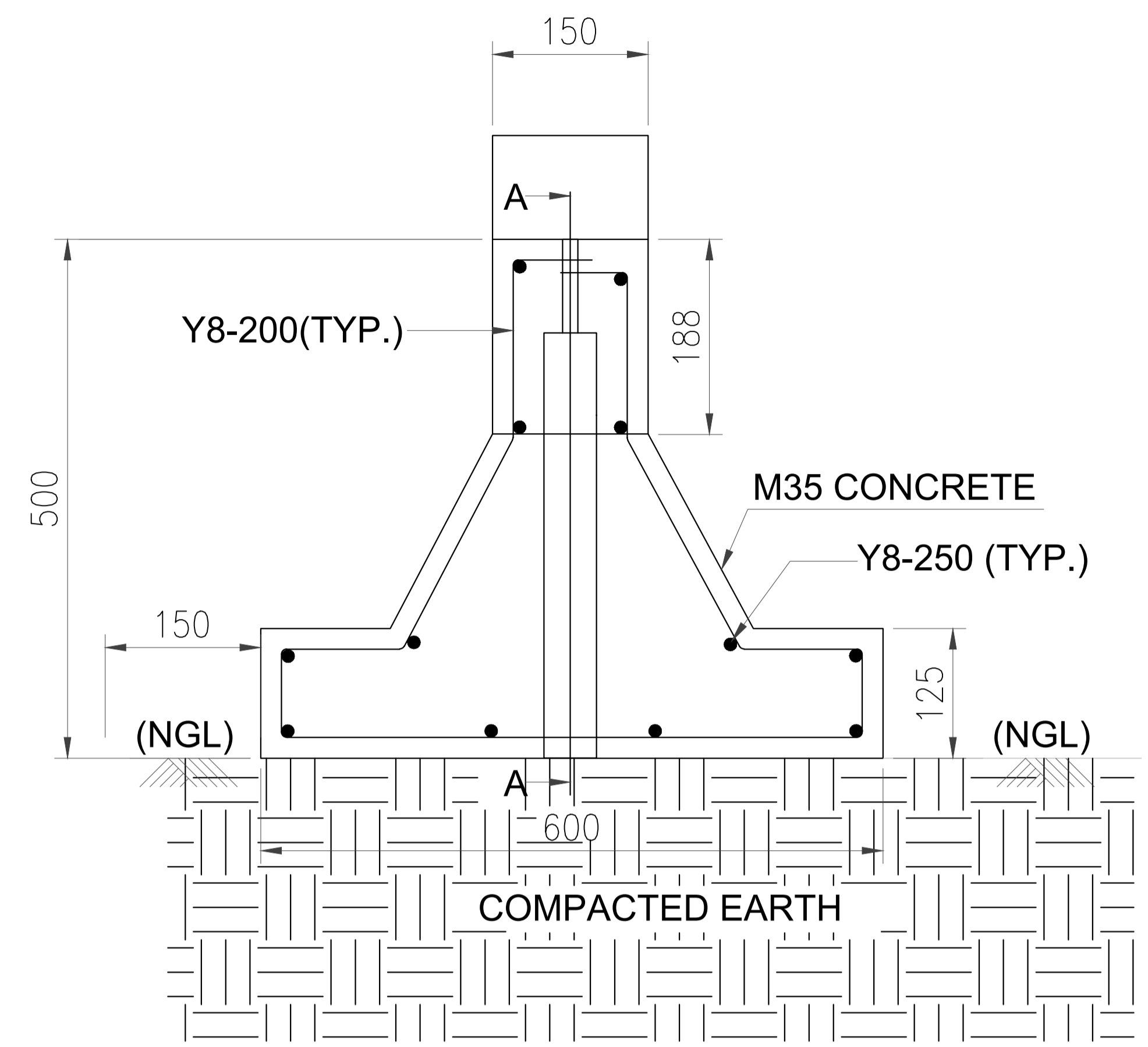

**TYPICAL C/S**  
NTS

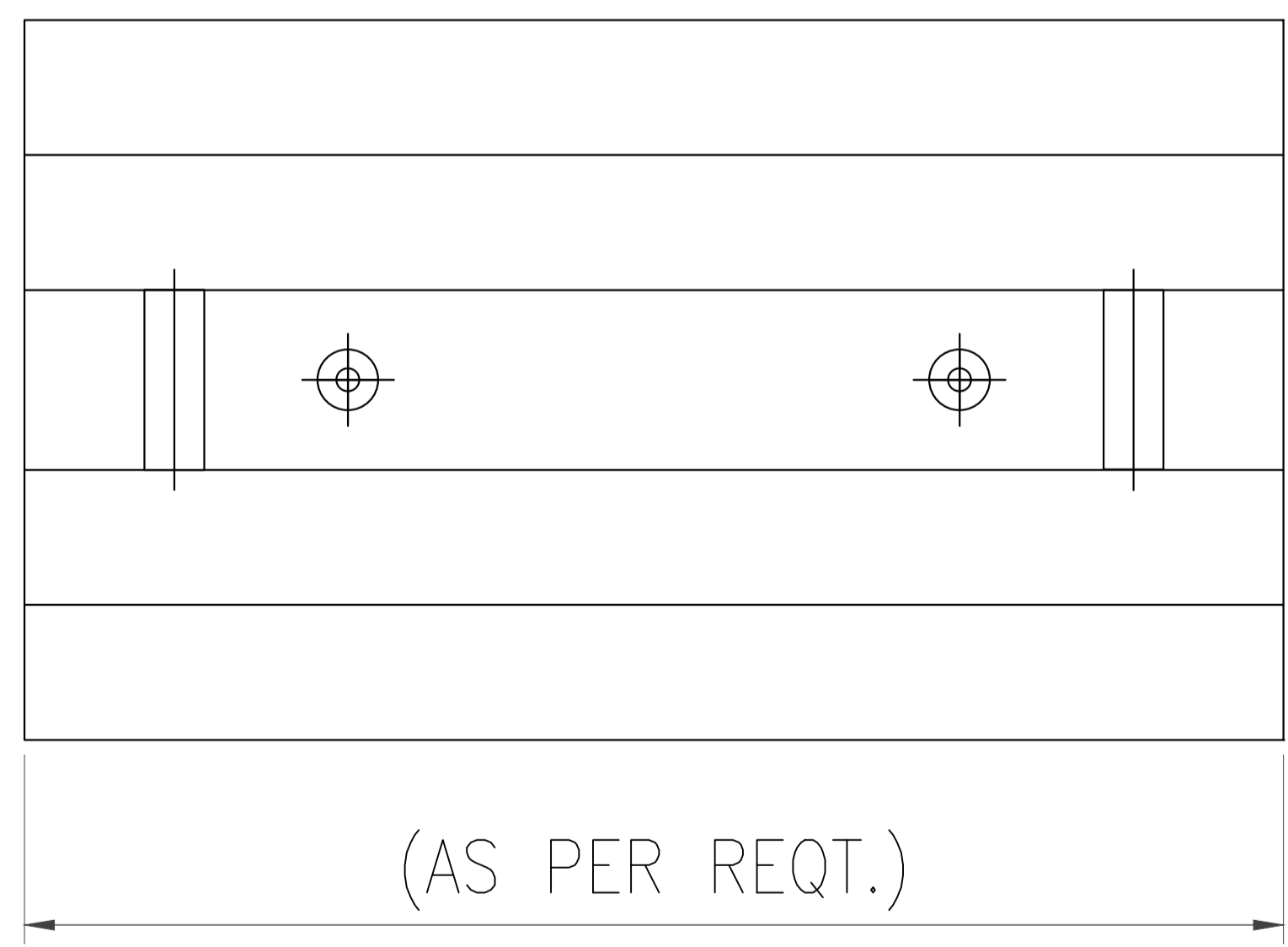

**TOP VIEW**  
NTS

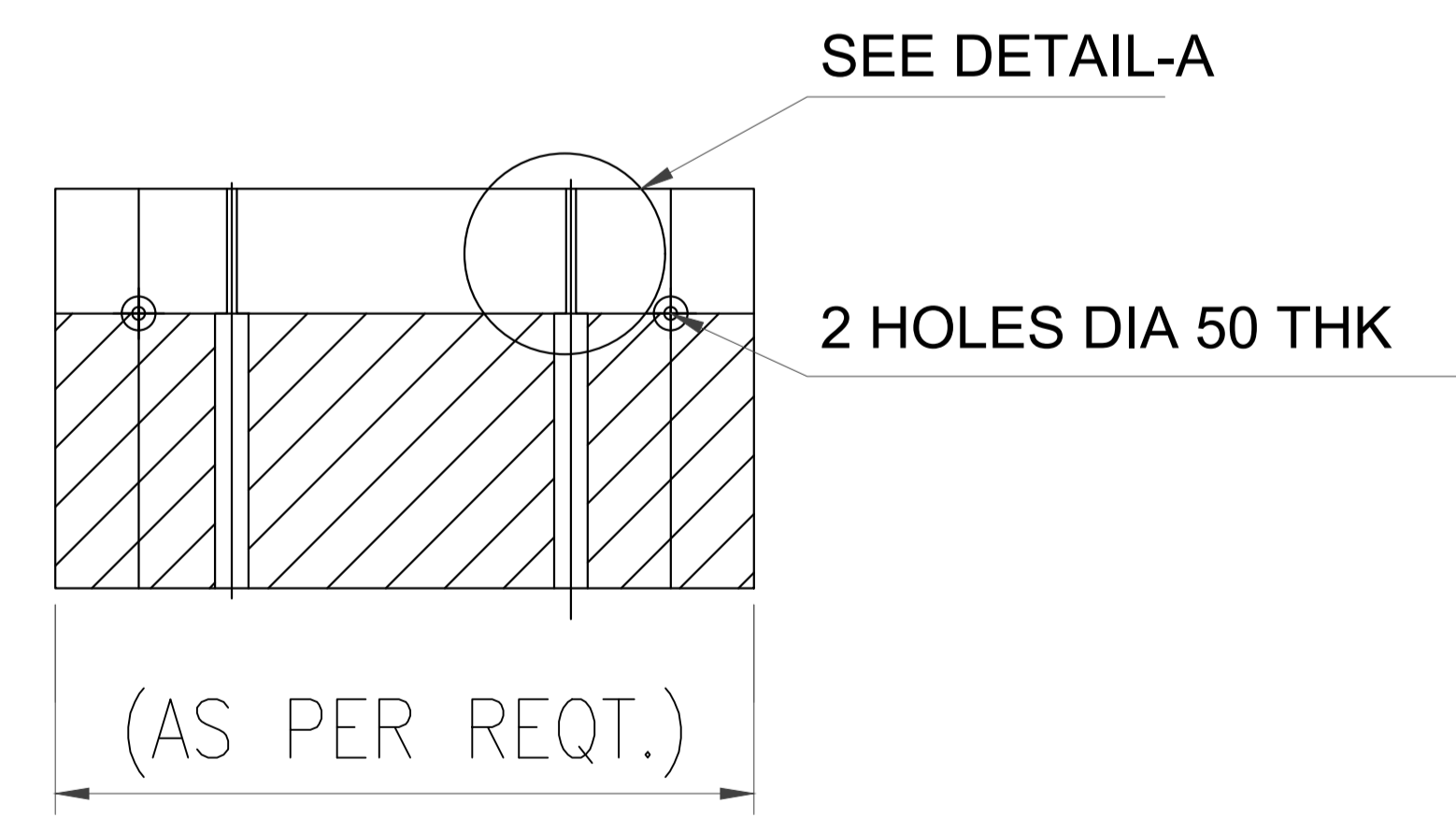

**SECTION A-A**  
NTS

**LEGEND**

|                             |                             |
|-----------------------------|-----------------------------|
| PCC - PLAIN CEMENT CONCRETE | Ø - DIAMETER                |
| NGL - NATURAL GROUND LEVEL  | GI - GALVANIZED IRON        |
| NTS - NOT TO SCALE          | THK - THICKNESS             |
| DET - DETAIL                | PVC - POLY VINYL CHLORIDE   |
| TYP - TYPICAL               | ISA - INDIAN STANDARD ANGLE |
| Eq - EQUAL                  |                             |
| T&B - TOP & BOTTOM          |                             |

- NOTE:-**
1. ALL DIMENSION ARE IN MILLIMETER.
  2. GRADE OF CONCRETE SHALL BE M35 WITH 20MM NOMINAL SIZE GRADED AGGREGATES AS PER IS:456.
  3. MINIMUM YIELD STRENGTH OF STRUCTURAL STEEL SHALL BE FY250.
  4. ALL REINFORCEMENT SHAL BE HIGH YIELD STRENGTH DEFORMED BAR OF GRADE TMT FE550D CORROSION RESISTANT STEEL (CRS) CONFORMING TO IS:1786.
  5. THIS IS INDICATIVE DRAWING AND BIDDER TO SUBMIT THE DRAWINGS INLINE WITH THE REQUIREMENTS FOR REVIEW AND APPROVAL.

**TENDER PURPOSE ONLY**

| REV. | DATE       | DESCRIPTION       | DRN. | STR. | MECH. | ELEC. | INST. |
|------|------------|-------------------|------|------|-------|-------|-------|
| 0    | 10.02.2026 | ISSUED FOR REVIEW | VU   |      |       |       | SK    |

**APPROVED BY**

|  |   |
|--|---|
| <b>FICHTNER</b><br>Consulting Engineers<br>(India) Private Limited<br>Chennai, Bangaluru | GUJARAT INDUSTRIES POWER CO. LTD<br>2375 MW CAPACITY SOLAR/WIND/HYBRID<br>RENEWABLE ENERGY PARK AT GREAT RANN<br>OF KUTCH AREA, GUJARAT |
|--|---|

|                           |     |            |  |
|---------------------------|-----|------------|--|
| DRAWN                     | VU  | 10.02.2026 | TITLE                                      |
| DESIGNED                  | DK  | 10.02.2026 | TYPICAL<br>RCC PRECAST CABLE SUPPORT BLOCK |
| CHECKED                   | SKP | 10.02.2026 |  |
| DEPT. HEAD                | SK  | 10.02.2026 |  |
| PROJ. MGR.                | RP  | 10.02.2026 |  |
| RELEASED FOR CONSTRUCTION |     |            |  |

|          |                                 |         |         |        |     |      |   |
|----------|---------------------------------|---------|---------|--------|-----|------|---|
| DEPT.    | ELECTRICAL                      | JOB NO. | 1721125 | SCALE: | NTS | REV. |   |
| DWG. NO. | FCE-1721125-RE-DWG-LAY-4100-004 |         |         |        |     |      | 0 |